

LINE SPECIFICATIONS

E-COM 1

Drum width	520 mm	20.47"
Max. paper width	up to 1300 mm	up to 51.18"
Max. production speed	up to 250 bags/min	

Bag making machine height (A)	2300 mm	90.55"
Bag making machine width (B)	2500 mm	98.42"
Bag making machine length (C)	5935 mm	233.66"
Full line length with optional devices (D)	18 790 mm	739.76"

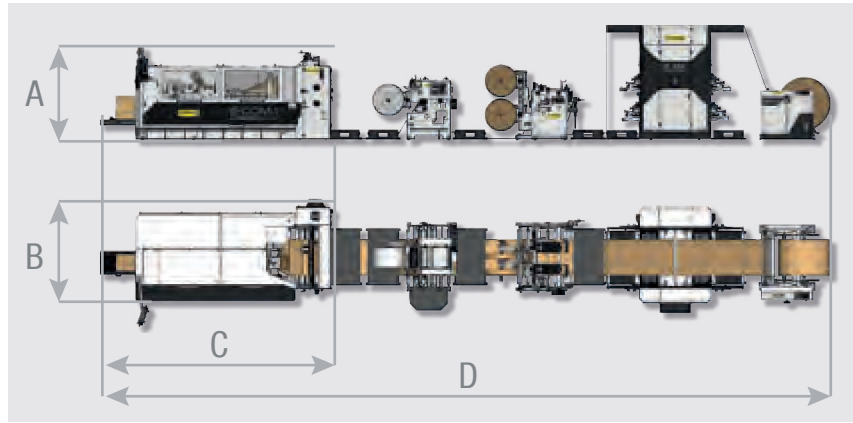

LINE EQUIPMENT

Strip unit



Cardboard unit



Flexographic printer



BAG SPECIFICATIONS

Bag width	90 mm - 480 mm	3.54" - 18.89"
Cutting length	320 mm - 760 mm	12.59" - 29.92"
Gusset depth	12 mm - 80 mm	0.47" - 3.14"
Flap height	up to 100 mm	up to 3.93"
Paper weight	70 g/m ² - 140 g/m ²	

OPTIONS



E-Com1 Video

Scan QR code :

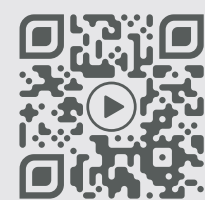

The HolwegWeber Group

HolwegWeber North America
+1 920 894 2221 - info@holwegweber.com

HolwegWeber Europe
+33 3 88 47 84 84 - holweg@holweg.fr

HolwegWeber Asia-Pacific
+86 20 3485 5787 / 5189 / 5797

www.holwegweber.com

Version: EN_A4_210831-P

E-COM 1



E-COMMERCE SOLUTIONS

Holweg

© HolwegWeber Group

INNOVATIVE AND SUSTAINABLE SOLUTION FOR E-COMMERCE

The packaging produced by the E-Com1 is biodegradable, reduces void space, and has a ship and return feature, which allows for reliable use and reuse. Thus, making this machine a solution that truly addresses the current environmental challenges facing the packaging industry.

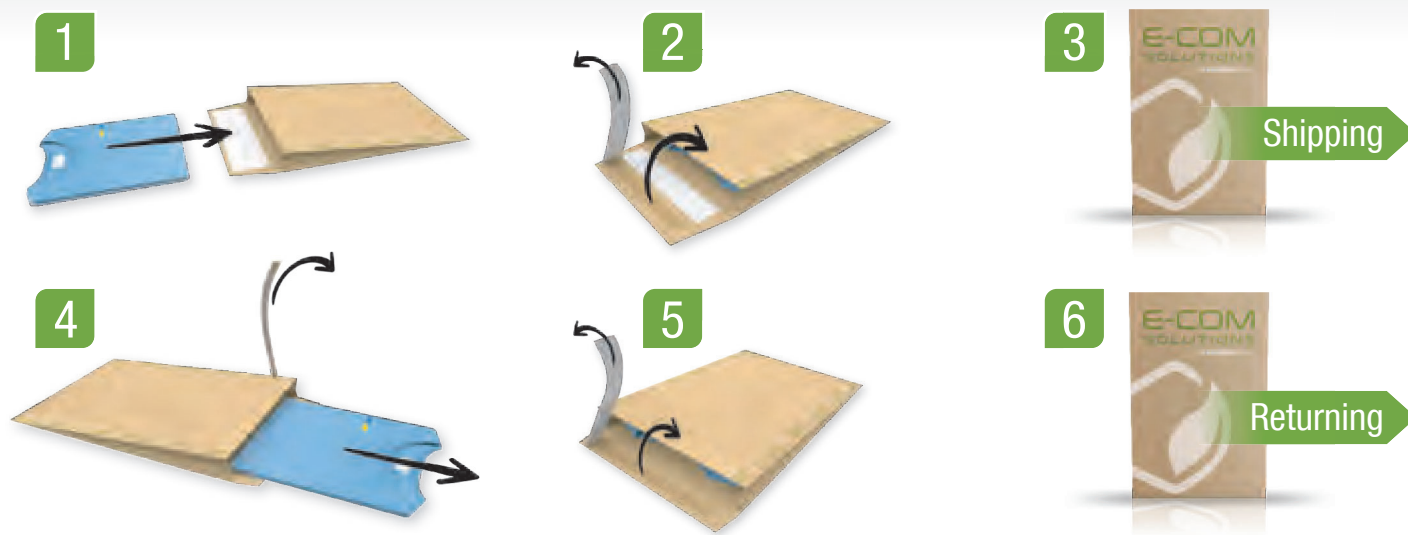
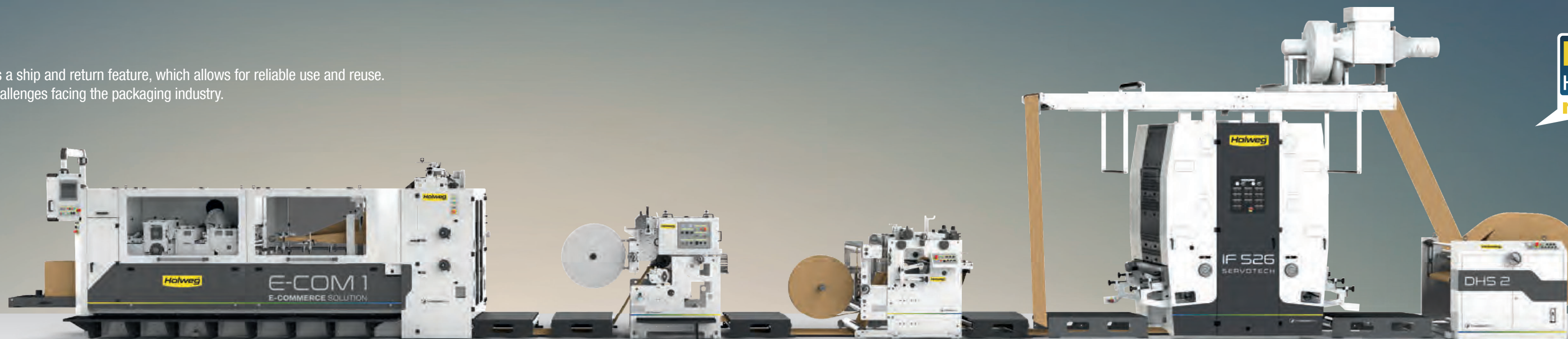

FRUSTRATION-FREE E-COM PACKAGING

The “Ship & Return” mailer bag has a unique gusset feature that provides the flexibility one needs to send out a variety of goods purchased online. In addition to this unique feature, the mailer bag also has a two-seal system that makes sending and returning goods easy and reliable.

How it Works:

- 1- Put an item into the mailer bag
- 2- Close the bag with the first strip
- 3- Send the bag out with the item inside
- 4- Easily remove the hassle-free seal
- 5- Put the item back in and reseal
- 6- Return the bag with the item sealed safely inside

MAXIMIZED OEE

Each device that makes up the HolwegWeber E-Com1 production line is equipped with reliable components, developed for easy setup, and an advanced ergonomic design which enables the operator to make change overs more efficiently, and maximizing the Overall Equipment Effectiveness.

